



Couplings, Pulleys & Sprockets



www.shaktipulley.com

**Pin Bush Coupling
(BC-Series)**

Product Range



Taper Lock Pulley



V. Belt Pulley



Timing Pulley



Poly V Pulley



Keyless Bush



Pin Bush Coupling



Tyre Coupling



Star Coupling



HRC Jaw Coupling



Gear Coupling



Sprockets

www.shaktipulley.com



Couplings, Pulleys & Sprockets

OUR FACILITY



BUSH TYPE FLEXIBLE COUPLINGS

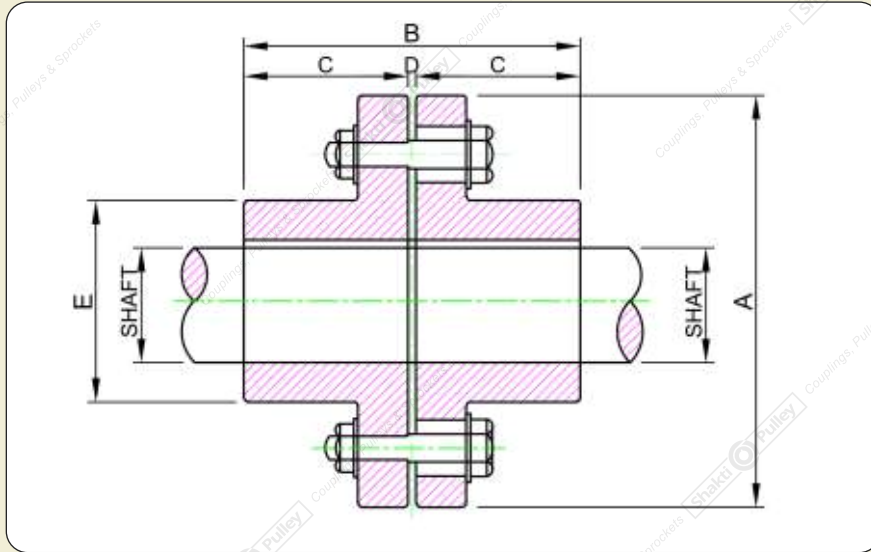

TABLE 1 - DIMENSIONS

Size	No. of Pins	Min. Bore (mm)	Max. Bore (mm)	A (mm) Dia	B (mm) Total Width	C (mm) (Flange Width)	D (mm) (Gap)	E (mm) (Hub Dia.)	Torque (Nm)	Max. Speed (RPM)	Power Rating 100 rev/min
BC-1	3	12.7	30	95	79	38	3	44	77	6100	0.81
BC-2	4	12.7	35	114	99	48	3	51	310	5100	3.25
BC-2A	6	16	45	130	105	51	3	67	516	4400	5.4
BC-3	4	16	50	160	107	51	5	75	621	3600	6.5
BC-4	4	20	70	191	125	60	5	105	831	3000	8.7
BC-4A	6	20	70	191	125	60	5	105	1241	3000	13
BC-5	6	25	80	225	155	76	5	115	1662	2600	17.4
BC-6	8	45	100	254	183	89	5	140	2359	2300	24.7
BC-6A	10	45	100	254	183	89	5	140	2932		30.7
BC-6B	12	45	100	254	183	89	5	140	3533		37
NBC-7	12	55	120	290	235	115	5	175	4154	1950	43.5
NBC-7A	14	55	125	300	235	115	5	185	5195	1900	54.4
NBC-8	16	60	135	310	255	125	5	200	5816	1850	60.9
NBC-8A	18	60	138	340	265	130	5	205	7268	1650	76.1
NBC-8B	12	65	142	360	276	135	6	212	8729	1590	91.4
NBC-9	13	70	152	390	316	155	6	225	9932	1470	104
NBC-9A	15	80	162	410	336	165	6	240	13274	1400	139
NBC-10	16	90	175	440	366	180	6	255	14420	1300	151
NBC-10A	17	100	185	480	386	190	6	270	18050	1200	189
NBC-11	20	110	195	530	406	200	6	285	23780	1080	249

Shakti Pulley reserves the right to alter non-critical dimension and specifications without prior intimation

All dimension in 'mm'

All Pulleys / Coupling are supplied without balancing. Balancing charges are extra if required.



Couplings, Pulleys & Sprockets

Shakti Pulley Manufacturing Company



Unit-1

Plot No. 28 / 3, Street No. 6, Anand Parbat Industrial Area,
New Rohtak Road, New Delhi

Unit-2

Plot No. 50, Sector-16, HSIDC, Bahadurgarh, Haryana

Unit-3

Plot No. 2, Sector-30E, IMT Rohtak, Haryana



Mobile No.:

+91 999 929 9050 | +91 98100 59086 | +91 80106 58403-06



mail@shaktipulley.com



www.shaktipulley.com

